



Newsletter



Activities are ongoing!

Welcome to our June Newsletter. We feature another of Tony Robinson's encounters with old buildings, this time a somewhat ordinary-looking workshop containing a surprising cruck truss inside. We also take a look at the intriguing coastal village of Staithes in our regular 'From the archive' article – an ideal destination for a summer outing!

Our annual day school in February on the theme of *Vernacular Architecture of the Yorkshire Dales* attracted a large audience and the excellent talks addressed a wide range of topics including those illustrated on this page. Regrettably we had to cancel, or at least postpone, our annual day school due to a shortage of organisational resource. However, we continue our productive work in Upper Wharfedale, and in late May we also held a fascinating event investigating Oakwell Hall. Our thanks go to Jan Goode for the former and Mark Womersley for arranging the latter, which we will report on at a later date.

Teams have been out and about recording individual buildings, including a cottage in East Ayton which proved to be more complicated than expected, with an earlier, possibly cruck-shaped, roofline and alterations in different building stone. In Bilsdale, members spent an enjoyable two days recording the unspoilt farmhouse and farm buildings at High Ellermire, as advertised in the last Newsletter.

Photos: features of the Yorkshire Dales, discussed at the day school. Clockwise from top: Dales field barns; decorative features on the porch at The Old Manor House, Clapham; wrestler roof sales at Hewbell Barn, Ribblesdale; and a 'Settle-type' window at The Folly in Settle.

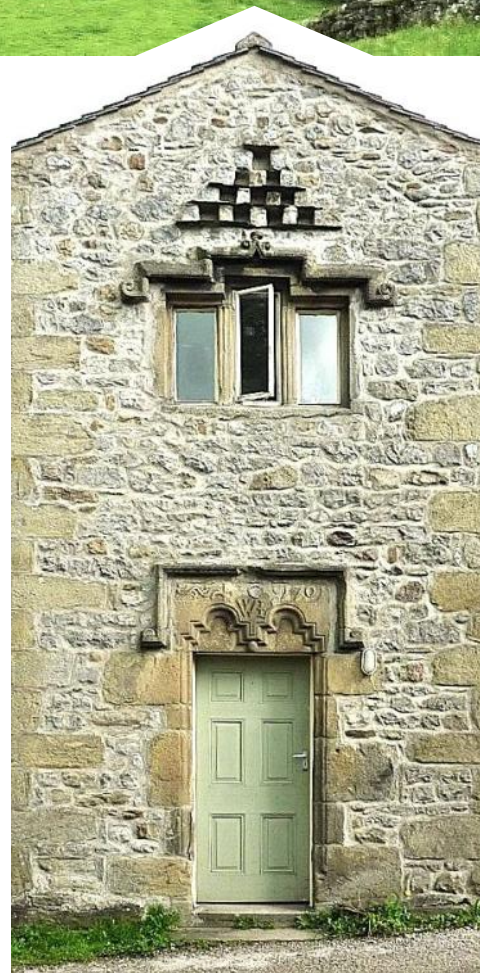

Future YVBSG events: dates for your diary

Baildon Hall and Baildon village walkabout

Saturday 20 June 2026

Our next event will be a full day in Baildon, West Yorkshire, arranged by Kevin Illingworth.

Baildon Hall (listed Grade II* and now a social club) is a gentry house of medieval origin with a cross-wing, probably of the late fifteenth century, cased in stone in 1673 with the timber-framing still visible inside. The *British Listed Buildings* website (britishlistedbuildings.co.uk) shows an early photo of the hall. We will meet at Baildon Hall Club, Hallfield Drive, Baildon BD17 6NH at 10.30am. Park at the rear of the club. The Hall will provide drinks upon arrival and at lunchtime; a buffet lunch will be available. President and local historian Mike Lawson will be our guide, and will also lead us to vernacular buildings in the Brook Hill area and in Baildon village later in the day.



Baildon Hall

The cost will be £13 per person (payable on the day) which includes buffet lunch and a contribution to the Hall.

Baildon Hall is accessible by public transport. It is an easy fifteen-minute walk from Baildon Railway Station to Baildon Hall. Alternatively use bus service number 626. There are frequent journeys from Bradford Interchange to Towngate, Baildon Village, which is higher up from Baildon Hall. Also, the Co-op Car Park on Northgate is free.

Maximum number 25. If you'd like to come, please email Kevin Illingworth on kevinillingworth1943@gmail.com or telephone 01422 844941 (please leave your telephone number if you email or phone).



Above: the staircase at Baildon Hall



Right: the three doorways in an earlier partition at Baildon Hall

Third Thursday Talks

These talks normally take place by Zoom at 7.30pm on the third Thursday of the month, although none are scheduled at present. We are always looking for volunteers to give future talks and if you are interested in doing so, please contact Mary Cook on secretary@yvbsg.org.uk.

Recordings of previous talks can be watched online by going to our YouTube channel at www.youtube.com/@yvbsg.

The latest addition to our channel is a talk by David Cook on Carr House Farm in Shelf, presented immediately before the AGM on Thursday 16 April 2026. Carr House Farm is one of the buildings recorded at the 2025 annual recording conference in the Bradford area.

Annual Recording Conference

We regret that the annual recording conference planned for Upper Wharfedale on 15-17 May 2026 was cancelled due to a shortage of resources to organise and run the weekend, but we will look at holding an event later in the year instead.

In the pipeline ...

We hope to arrange further events during the year and will circulate details by email when finalised. In the meantime, opportunities to get involved in recording continue to arise from time to time so do get in touch with the Archivist, David Cook, on archivist@yvbsg.org.uk if you're interested. Not done it before? Don't worry – enthusiasm is as important as experience!

Visit to Foulbridge Hall and Lastingham

Friday 24 July 2026

A day in the Vale of Pickering and North York Moors organised by Pamela Martin. The programme will include the following.

- 11.00 am. Visit to the Foulbridge Knights Templar Preceptory, YO13 9AZ (near Snainton, North Yorkshire), a Grade 1 listed building discovered on the Foulbridge Farm site in the early 1980s. This timber-framed aisled hall dates back to the thirteenth century. Andrew Nutt, the present owner, will give an introductory talk and there will be time to explore the building and documentary evidence. We'll meet at the farm – exact details of location will be given on booking.
- 1.00 pm. Buffet lunch at the Barn Guesthouse and Tearooms, Hutton-le-Hole, North Yorkshire, YO62 6UA. Enter the village from the main Helmsley/Scarborough Road (A170). Located on the right-hand side of the main street in Hutton-le-Hole at the centre of the village.
- 2.30 pm. Visit to Lastingham St Mary's Parish Church YO62 6TL. This Norman Perpendicular Gothic church was founded c654 as a Celtic monastery by St Cedd of Lindisfarne. The unique Norman crypt is significant for its structure. The Revd Haddon-Reece, who has a particular interest in vernacular architecture, will lead the tour of church and crypt. Meet at the church. Street parking in the village.



Foulbridge Hall

Cost: £20 per person, which includes a buffet lunch and donations to both establishments. Own transport, walking shoes advisable. Booking essential. Full instructions on how to book will be circulated to members by email later in June – in the meantime, keep the date!

The invaluable benefits of local knowledge

Welcome to the Group's June Newsletter. I was delighted that around 120 people came to our annual day school in Skipton back in February. Thanks to everyone involved in the organisation and helping at the event, and particularly to the speakers for providing stimulating talks. A lot of effort goes into making these events happen and that's especially pleasing when they are well-supported.

Over the past year members of the Group have recorded about a dozen buildings, sometimes with local people. For me, working with someone who knows the history of an area well brings many advantages. They will be able to point us in the direction of interesting buildings, particularly those tucked away in an area that has changed substantially. Our visit last year to Wibsey, Low Moor and Shelf, south of Bradford, illustrated this aspect very well, and we are very grateful for the time and effort put in by local experts. Who would have thought that a building like Chapel Fold was lurking in the nineteenth- and twentieth-century expansion that swallowed up the countryside around Wibsey?

Towards the end of last year we started a project with the Upper Wharfedale Heritage Group. This was initiated by our Treasurer, Jan, who was keen to revive interest in the buildings of the area. From the 1970s to the 1990s, through the joint efforts of our predecessors and the Upper Wharfedale Field Society, a good number of buildings were recorded in Wharfedale. Since then there have been many changes – to the survey personnel (ageing), the buildings and the methods of recording. We are taking the opportunity to revise and update our guidance to meet current standards.



Chapel Fold, Wibsey

To make sure we're doing as much as we can to make membership worthwhile, we'd like to check with you, particularly as we have quite a number of new members. To this end, we've put together a questionnaire which can be filled in online; members should have already received an email message containing the link. We'd appreciate this being completed so we can plan accordingly.

Looking forward to a successful year for the Group.

David Cant, Chair, enquiries@yvbsg.org.uk

Upper Wharfedale Vernacular Building Project – an update

In 2025 the Yorkshire Vernacular Buildings Study Group and the Upper Wharfedale Heritage Group initiated a joint project with the objective of increasing vernacular building recording skills in the Upper Wharfedale area. Both groups have a background of building recording in the area although few recordings have been done in recent years.

The project kicked-off on 15 November 2025 with a full day event in Conistone in Upper Wharfedale attended by local members of both YVBSG and Upper Wharfedale Heritage Group. The morning session included presentations on how the YVBSG approaches building recording, including both building surveying and archival research, to understand how a building has evolved over time. In the afternoon, there was an opportunity for members to get some practical experience of building surveying as well as a visit to a cottage that has already been recorded to understand what features are significant in dating a building and understanding how it may have developed over time.

The focus on Upper Wharfedale continued with the very successful day school held on 28 February 2026 in Skipton Town Hall which had a record attendance of 120 people. The topic was *Vernacular Buildings of the Yorkshire Dales* and there were talks from a wide range of speakers including Adam Menuge, Course Director for the MSt in Building History at the University of Cambridge; Dr David Johnson, a historical geographer and landscape archaeologist based in the Yorkshire Dales; and Kate Holt from the Landmark Trust who gave a talk on Cowside, a Landmark property in Langstrothdale.

The first building recording training day was held on 14 March 2026. The day started at Buckden Institute with a presentation on characteristics used to date and define vernacular buildings. This was followed by an overview of the history of the village of Starbottan, focusing on how the village layout and the buildings changed over time. Next was a walk around Starbottan identifying key features of the vernacular buildings, many dating to the seventeenth century. The morning finished with the group sketching the front elevation of one of the buildings, putting into practice some of the learnings from earlier in the day. Back in Buckden, Mark Womersley gave a demonstration of how to use CAD to produce a front elevation drawing using data from the morning session.



On 18 April 2026, members of the group took part in an instructor-led building recording of the cottage studied on the training day in Starbottan. Three groups took measurements and observation notes, each group getting experience of an external elevation and an internal floor plan. Members of the group are now preparing the drawings and text for the building report.

Future building recording events are being planned in Upper Wharfedale, mainly focused on villages that are under-represented in the YVBSG archive.

Jan Goode, treasurer@yvbsg.org.uk



Recording High Bentley – thirty-odd years ago!

High Bentley at Shelf in West Yorkshire is an important late medieval timber-framed aisled hall, dating from the second half of the fifteenth century and encased in stone in 1661, with an added rear kitchen wing of c1665.

The photograph shows a youthful Peter Thornborrow, our former chair, carrying out building recording at the house for West Yorkshire Archaeology Service (photo taken in 1989 by Paul Gwilliam). Peter listed the house as Grade I in c1988 and his work on the building helped to rescue it from an owner who had allowed it to deteriorate. It was restored in the 1990s and was offered for sale last November for £1.5 million, and has recently been sold.

Further information on the house can be found in the RCHME volume *Rural Houses of West Yorkshire 1400-1830*.

Love the snazzy orange dungarees, Peter!



Jane Hatcher

I was sorry to hear about the death of Jane Hatcher on 27 May 2026. She was born in York, graduated in Architectural Studies from the University of Newcastle-upon-Tyne and later received a Masters degree for research in architectural history. She settled in Richmond, North Yorkshire, where she studied the people, the town and the surrounding area. This resulted in many publications including *Richmondshire Architecture* and most recently *Richmondians – Nine Centuries of Men and Women of this Yorkshire Town*. One of the first I came across was *The Industrial Architecture of Yorkshire*, published when I was studying at Ironbridge in the 1980s.

Between 1984 and 1988 she worked on the Historic Buildings and Monuments Commission's re-survey of listed buildings. For our Group, she was instrumental in setting up a couple of recording events in Richmond, based on her extensive knowledge of the town and its buildings, and gave a talk on industrial buildings at our 1994 annual conference in Swaledale. More recently she was a keen supporter of our online talks.

David Cant

Alastair Laurence

We are sad to report the death of YVBSG member Alastair Laurence. Alastair was awarded a Masters in history at Leeds University and became a keen local historian of Horsforth where he previously lived, as well as of Rawdon and Menston. His book, *A History of Menston and Hawksworth* (1991), was referred to in our last Newsletter in connection with Menston Hall.

Professionally he was involved in manufacturing early keyboard instruments such as spinets and was Director of Broadwood's Pianos in Whitby, where he gave jazz trio performances.

From the AGM

At the AGM on Thursday 16 April 2026, officers and committee members were elected as follows:

- Chair: David Cant
- Honorary Secretary: Mary Cook
- Treasurer: Jan Goode
- Membership Secretary: Pat Leggett
- Archivist: David Cook
- Yorkshire Buildings Editorial Team Liaison: Tony Robinson
- Newsletter/website/social media: Lorraine Moor
- Committee Members: Kevin Illingworth, Sue Southwell, Peter Thornborrow, Gunhild Wilcock, Mark Womersley

The minutes of the AGM and the latest accounts are now on the Members' Area of the website.

Next committee meeting

The next meeting of the full committee will be held on Saturday 6 June 2026. If you'd like to raise any matters at any time, or have ideas for future events, please contact the Secretary, Mary Cook.

Next Newsletter

The next Newsletter will be in August 2026 – please send any contributions to the editor at newsheet@yvbsg.org.uk by 31 July 2026. Short articles on buildings or features would be appreciated, as well as details of publications or events of interest to other members. Is there a particular building or feature which puzzles or intrigues you? Do tell us about it!

Could this be a ship's timber?

Whilst recording a cottage recently in East Ayton near Scarborough, we popped into the Church of St John the Baptist next door for a quick look round. Eagle-eyed team member Gunhild Wilcock spotted this curved piece of timber forming the lintel of the church porch. The team couldn't identify it as a timber from a building and we suspect it could be one of those rare things – a reused timber from a ship!



Ivan Hall

The architectural historian Ivan Hall died recently at the age of 93. Dr Hall led the fight for the preservation of many historic buildings, and had a huge impact on conserving the historic centres of Beverley and Hull. In Beverley, he was involved in preserving houses in the majority of the historic streets: Ladygate, Saturday Market, Highgate, Railway Street, Flemingate, Keldgate, Newbegin, Hengate, Walkergate, Lairgate, Toll Gavel and Beverley Friary. He bought and restored a dilapidated medieval building in Ladygate, earmarked to make way for an expanded bus station.

He was an expert on the eighteenth century Yorkshire architect John Carr and produced various works on Carr. He was also the author of informative publications on *Historic Beverley* (1973) and *Georgian Hull* (1979). An obituary can be found at www.hulldailymail.co.uk/news/history/tributes-architectural-expert-ivan-hall-10851460?

Rural life in Fryup

The Danby Rural Life Collection tells the story of farming before the advent of tractors, running water and electricity. This revamped exhibition of tools and household items has gone on display at the 1834 stables and hayloft of Stonebeck Gate Farm, Fryup, after undergoing a major programme of conservation.

The original collection was created by the late Dr Bob Robinson and Rev David Adam in the 1960s and 1970s, and has been catalogued and redisplayed with new interpretations. It has been added to with donations from farms in the Eskdale area. Exhibits include peat and haystack cutters, pitchforks, butter churns, cooking irons, a hand-cranked early washing machine and everything needed to hitch horses to a plough. Every item has been reconditioned by a museum conservator, by exhibition designer Bill Bevan and a team of National Park Authority volunteers. Volunteers have also recorded the stories of local farmers.

Free entry. There is a café at the farm, next to the museum – The Country Cooks Larder, telephone 07527 680880, www.facebook.com/JillKellyTheCountryCook.

Stonebeck Gate Farm is a grade II listed building and features in the RCHME publication *Houses of the North York Moors* (1987), p162 and 185. Stonebeck Gate Cottage (but not the farm) has been recorded by the YVBSG (report 1025).

The Old Hall, Thoraby

Another fine Yorkshire building recently came up for sale. Thoraby Old Hall in Bishopdale is Grade II* listed, and was recorded by the Group in 1975 (YVBSG 0112). The porch is dated 1641 and the building is a fairly early example of a double-pile house. Inside is an inglenook fireplace with stop-chamfered segmental arch with masons' marks. The Hall had detached farm buildings, and on the end of one barn the outline of a cruck appears. The deadline for offers has now passed but at the time of writing details can still be viewed at robinjessop.co.uk if you'd like an online peek inside.

Calling any film producers!

Do you have skills in video production? We are toying with the idea of making one or more short videos to publish online, to illustrate what is involved in recording a building (and how it can be fun to take part!).

If you are interested, or would like to know more, please email enquiries@yvbsg.org.uk.

Weald publications now available online

David and Barbara Martin, well-known and longstanding members of the Wealden Buildings Study Group and honorary members of the Vernacular Architecture Group, have provided free online access to a number of their publications including two that were never available in print.

The publications focus on the Weald area and cover domestic building construction, farm buildings, medieval villages and towns such as Hastings and Rye. These can be downloaded from www.wealdenbuildings.org.uk/learning/david-barbara-martin-reports.

It is hoped that David and Barbara's two thousand building reports will also be available online by the end of this year.



Rye

Encounters with old buildings

10 Wilson Place, Heeley, Sheffield 8

The Victorian suburbs of Sheffield would appear to offer slim pickings for those in search of vernacular buildings. However, there are surprises to be had, such as this rather unprepossessing rubble building in Heeley, about two miles south of the city centre.

Listed in 1995, this is a cruck-framed former barn, with two pairs of 20cm x 20cm cruck blades, the feet of which are buried in the side walls. The cruck-frames have collars and saddles at the apex supporting a ridge piece. There is a single straight windbrace, and massive 20cm square purlins to each roof pitch.

The list description gives a date of circa 1600, with nineteenth century alterations and twentieth century additions.

The building is roofed in corrugated steel sheet, and for many years was the Enterprise Foundry of Ernest Wright, general iron founder. Use as a foundry ceased in the 1970s, but at the time of listing the building was in use as a pattern maker's workshop, this use also ceasing later.



Surprisingly, given its neglected appearance, the building is still in use as a workshop and store for an ornamental ironwork business, but as the owner told me 'We like to keep a low profile'. The owner was unwilling to let me take photographs of the interior, or even step inside, so (after a couple of previous fruitless visits) I was only able to peep inside.

However, there are a number of photographs online (www.picturesheffield.com) dating from 1971 and showing the foundry in operation. The cruck structure appears to be little altered since this date.

Tony Robinson, editor@yvbsg.org.uk

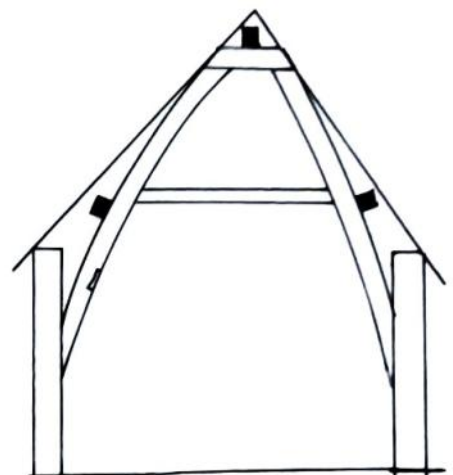
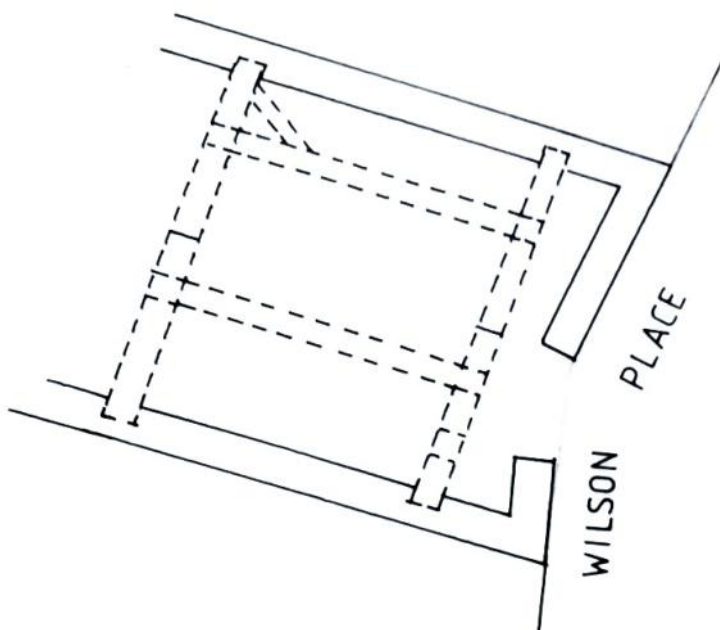

From the archive: A focus on Staithes

Staithes is a village in the civil parish of Hinderwell. The settlement straddles Redcar and Cleveland on the Cowbar Nab side of Staithes Beck and North Yorkshire on the southern side. During the nineteenth century, Staithes was the largest English fishing station north of the Wash. There was a thriving coastal trade. Staithes families owned nearly 20,000 tonnes of shipping and more than a hundred master mariners came from the town. The Staithes Shipping Company and the Staithes Iron Company flourished in the nineteenth century. The opening of the Whitby, Redcar and Middlesbrough Union Railway in 1883 meant that fish could be transported without the need of pack horses carrying their cargo to Grosmont. Over time, the fishing industry declined and the railway was closed in 1958. However, there is

still evidence of where the railway viaduct stood.

The sea brought trade and prosperity to the area. However, fishing was a hard life. Whole families supported the venture, from ship making, sailing cobsles, helping to beach the boats and preparing fish for market. Women played an important part in the business, including line baiting and pushing the boats out into the water.

The sea brought wealth, but also danger to Staithes. There are numerous accounts of storm surges flooding the area and destroying properties. There is an account from October 1849 of several houses being carried away, but a grandfather clock was carried to safety in a hand cart. Postcards from 1908 depict the sea flooding the High

Street and causing destruction. Work started on the much needed breakwater in the 1920s.

Today, Staithes attracts many tourists who come to see the narrow streets and passageways. The buildings are in close quarters and often wrap around each other. This shows the need for accommodation when Staithes was at its height in commercial activity. Residents had to compromise on living space, internally and externally. Some of the gunnels are still used to store lobster pots and this gives a sense of the smells and sights that would have been commonplace in the past.

The YVBSG has recorded 13 buildings in the village. The reports featured below can all be found in the YVBSG online archive.

Mary Cook

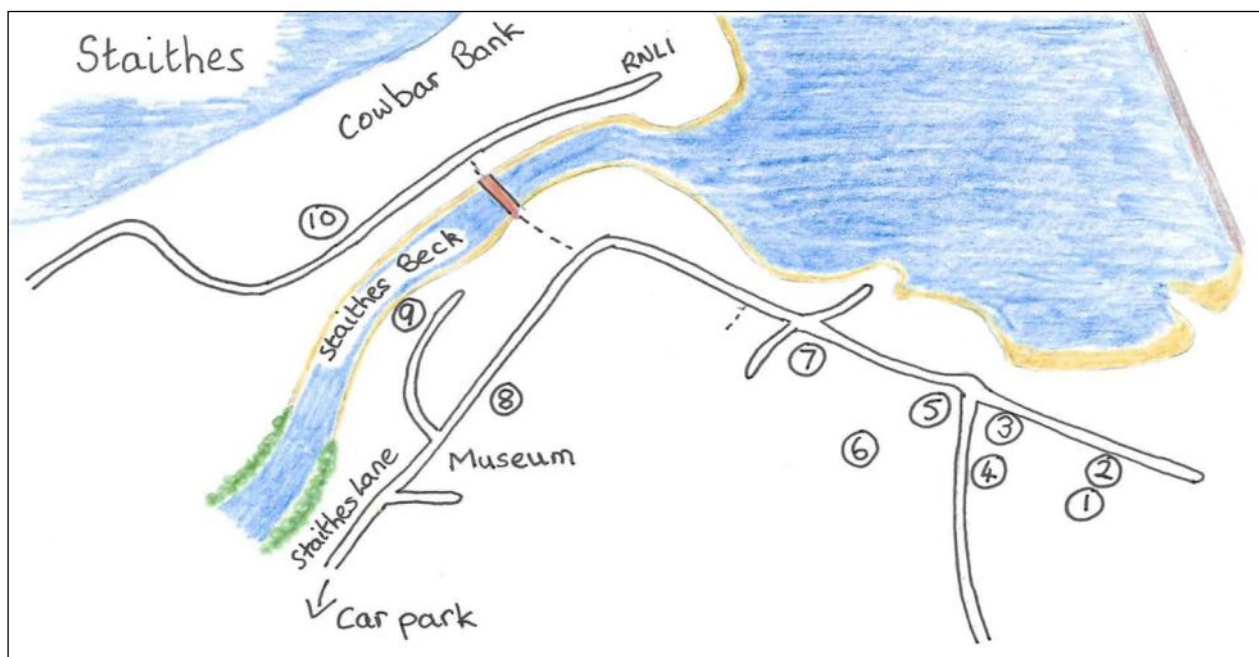

1. Shale Cottage (YVBSG 0934). It is likely that this was originally a very low single-storey thatched fisherman's cottage. The roof was raised and a crab boiling building added. The fireplace was moved to the south gable wall. This was possibly an end-lobby-entry cottage.

Other buildings recorded by the YVBSG in the village but not featured in this article are:

Sunny Side (YVBSG 0924)
Gugs Cottage (YVBSG 1051)
Laura Knight Studio (YVBSG 1871)



2. Harbour View (YVBSG 0933). This building is all that remains of a group of thatched cottages which were apparently arranged in a square. Storms washed away the other buildings. The outer wall was likely to have been built to protect the cottage from the scourge of the sea.



3. Sea Drift Shop (YVBSG 0926). A jointed cruck truss can be seen in the roof of this building, with the lower parts extending into a bathroom and a bedroom. This dates the building to about 1750.



4. Kirkhill House (YVBSG 0925). Sadly, this house is now in need of some restoration. Likely built in the 1760s, the house was furnished with panelling, moulded door frames and a 'very fine' central staircase.



5. Captain Cook's Cottage (YVBSG 1055). Local tradition says that this building incorporates materials from the haberdashers and grocery shop where James Cook was apprenticed in 1745.



6. Friendship Cottage (YVBSG 1900). This building contains a pair of raised crucks across the centre, tentatively dated to about 1750. Staithes' oral tradition claims that Friendship Cottage was once a Quaker meeting place, but no documentary evidence has yet been found to support this in Quaker records.



7. Sea Crest (YVBSG 1077) stands on a huge platform of natural rock, originally the base of a cliff, with the gable facing across the harbour. A lean-to kitchen belongs to the cottage but is structurally separate from it. Such 'detached kitchens' are a common feature of fishing villages on the North Yorkshire coast.



8. Greystones (YVBSG 0937). This handsome building on High Street has a front and back range, built at different times. It is likely that these were two dwellings. The floor level is different in each range.

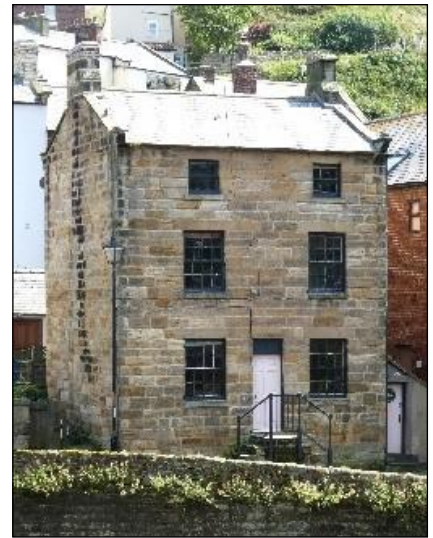

9. Beckside (YVBSG 0938). This is a tall sandstone house, two-and-a-half storeys high and almost square on plan facing west across Staithes Beck and lying a little to the south of the bridge.



10. Numbers 4 and 5 Cowbar Bank (YVBSG 1941). A pair of cottages with a raised cruck between no 4 and no 5.

Latest news on some buildings featured previously

Kevin Illingworth provides an update on some buildings mentioned in previous Newsletters or visited during past events.

The Hare and Hounds Inn, Old Town, Wadsworth, near Hebden Bridge

This unlisted pub of c1800 is for sale again, soon after having been sold to a property developer in 2025, who wanted to convert the pub into housing. Atkinson Associates of Ikley are inviting offers in excess of £500,000 for the freehold property. On 8 April this year Calderdale Council listed the pub as an Asset of Community Value (ACV). The owners are now in contact with Wadsworth Area Community Assets (WACA), who want to buy the pub for the community. If the Wadsworth group have not seen these small false windows or know their purpose regarding the reduction of Window Tax, I could help! For more information on The Hare and Hounds and three more Calderdale houses with these square 'windows', see *Newsheet* No 102 (March 2021) page 4 and *Newsletter* No 122 (February 2026). Also *Yorkshire Buildings* No 50 (2022) pages 49-56.

In Lancashire at least two brick-built houses are known to have reduced Window Tax by linking the upper and lower windows by means of vertical channels of glass. Illustrated is the rear wing of Shepherd's Farm, Cockerham, near Lancaster, dated 1705, where the channels are four inches wide and two inches deep. The wing was sketched before 1990 by the late Richard Watson, VAG member. The 'windows' were restored around 2012. The late Ralph Cross of Burnley photographed this farmhouse in 1970.



Shepherd's Farm, Cockerham

Jones' Barn, Rodwell End, Todmorden



A group of members visited this barn dated 1749 in September 2021, on our first Todmorden walk. The listed building description names it as 'Barn north of Lad Stones'. For thirty years or more, anyone could just walk in to see those three transverse, pointed stone arches, but not anymore, as this 'cathedral' barn has been converted into a house.

For more information about these stone-arched barns, see *Yorkshire Buildings* No 49 (2021) page 70, and *Newsheet* No 105 (December 2021) page 4, and *Newsheet* No 104 (September 2021) page 3.

Lamb Working Men's Club, Barrowford

On 21 October 2023, our seventeen-strong group visited Barrowford and Roughlee. At the Grade II* listed Lamb Working Men's Club, we noticed that three of the large finials over the porch had been taken down due to concerns about their safety, and that some of the mullions were eroding. Nine new ogee-moulded mullions have now been inserted – three in the porch window and six in the cross-wing. Other worn stones have been replaced.

There is no access to the roofspace but a committee member is hoping to see the roof structure sometime! The original 1696 datestone has been found. The two outer porch finials have not yet been returned to their kneelers.

Kevin Illingworth



Gables of the East Riding

Look around the East Riding and you'll probably come across some interesting gables. We've featured some of them in previous Newsletters; here are three more.

Lorraine Moor

Lofts for storage

We often see taking-in or loading doors, or maybe pigeon holes, in the gable walls of attics in houses. It's perhaps less common to find ventilation slots as seen in this eighteenth century lobby-entry farmhouse with rear wing, Valley Farm in Sancton, which presents three vertical slots in the gable of the main range.

Other features of note here are the brick tumbling, the cornice on the front elevation and the kneeler with a faintly inscribed date of 1770.



Make an impression!

This ornate gable is at Southwood Hall, Cottingham. The house was recorded by the Group in 2007-8 (YVBSG 1753). Dendro-dated to 1662, it is thought to have been built by William Catlyn, a Hull architect/bricklayer known for his Artisan Mannerist style. The two 'I' symbols could be for John and Jane Bacchus ('I's are sometimes used to represent 'J's) who were living in the house by July 1662.

Spot the date ...

It's always satisfying to come across a dated building like this brick barn at Ulrome in Holderness. It has not been recorded by the Group, but is mentioned in the East Riding Pevsner volume: 'a brick barn at West End Farm has a tumbled gable with tie-plates in the form of the figures 1764'.



Other events of possible interest ...

We recommend that you check for any updated information if you plan to attend an event, in case of late changes to schedules.

Calderdale Heritage Walks

A programme of walks looking at the history of the area, normally on Sundays, usual fee £4. Further details at calderdaleheritagewalks.org.uk.

Open Farm Sunday

Sunday 7 June 2026

A variety of farms open to the public. Included is New Hall Farm, Ardsley, South Yorkshire S71 5EZ. 10.30am to 3.30pm, free. YVBSG members visited the cruck barn here in June 2010. Also open is Hare Appletree Farm, Quernmore, near Lancaster, LA20QP. Open 11am – 4.30pm. Surveyed by VAG member R C Watson in 1983, and has decorated doorheads of 1682, 1667, 1640, and 1662. For a full list of open farms see farmsunday.org.

Traditional Buildings of the Area

Monday 8 June 2026

A talk by David Cant to Wibsey Local History Group, 2pm at the Methodist Church, School Lane, Wibsey. BD6 1QX. £2. www.sblha.com/wiblhg.html.

Settle – A town full of history

Wednesday 17 June 2026

A guided walk at 2pm by Richard Handscombe for Malhamdale Local History Group, looking at the history and stories behind some of Settle's old and interesting buildings. £4. mlhg.org.

Walk around Bainbridge

Wednesday 17 June 2026

Guided walk with Martin Garside looking at historical buildings around Bainbridge. 2.00-3.30pm. Free, no need to book, meet by the stocks in Bainbridge. Friends of the Dales Countryside Museum event, www.dalescountryside-museum.org.uk.

Hull History Centre Tours

Saturday 20 June 2026 and other dates

A free one-hour tour through the strongrooms and conservation areas with a chance to look at some exciting historic documents along the way. www.hullhistorycentre.org.uk.

Magical Protection Marks

Saturday 20 and Sunday 21 June 2026

Short 15-minute talks at Ryedale Folk Museum to explore the world of magical protection marks. Saturday at 11.30am and 6pm, Sunday at 12pm, 3pm and 6.30pm. Included in normal museum admission ticket. www.ryedalefolkmuseum.co.uk.

Searching for the Footprints of a Medieval Village in Shadwell

Tuesday 23 June 2026

A guided walk around Shadwell with Leeds Civic Trust, giving a brief history of the manorial three field system and later growth, with quarries, rivers, wells and much more! 2pm to 3.30pm, free. leedscivictrust.org.uk.

Temple Newsam Rooftops and Cellars

27 June to 13 September 2026

Guided tour on various dates. £25 per person. Further details at museumsandgalleries.leeds.gov.uk/whats-on/rooftop-and-cellar-experience-lqdg.

Visit to Baildon Hall

Wednesday 8 July 2026

Visit to Baildon Hall, Hallfield Drive, by Bradford Historical and Antiquarian Society. Meet there at 10.30am. £10. Booking required, details at www.bradfordhistorical.org.uk.

CBA Festival of Archaeology

Saturday 18 July to Sunday 2 August 2026

Annual programme of events to celebrate archaeology, open to the public. Full listing available at www.archaeologyuk.org/festival.html.

Cropton and Sinnington

Sunday 19 July 2026

Two separate guided walks (Cropton morning, Sinnington afternoon) exploring the history of the villages with Jim Hall. North York Moors National Park Authority events, free, book at www.northyorkmoors.org.uk.

A Walk around Wibsey

Wednesday 12 August 2026

A walk with Mary and Geoff Twentyman for Bradford Historical and Antiquarian Society. Meet in the Salvation Army Car Park, Holroyd Hill, at 10.30am. No charge, no need to book. www.bradfordhistorical.org.uk.

Barns, Walls and Bridges

Tuesday 18 August 2026

A 4-mile walk discovering important features of Wensleydale. £6. 11am – 3pm. Starts at Dales Countryside Museum, Hawes. Yorkshire Dales National Park Authority event, www.yorkshiredales.org.uk.

Yorkshire Towns Through the Ages

Saturday 10 October 2026

Yorkshire Archaeological and Historical Society conference in York, in conjunction with the Historic Towns Trust. The event will look at towns and cities across the county in different historical periods, and discuss how maps can be used as a tool to represent these stories. No details as yet but keep an eye on the conference website at www.yas.org.uk/Meetings/Yorkshire-History-Conference-10-October-2026.

Scarecrow Festivals

Kevin Illingworth reminds us that scarecrow festivals offer a good excuse for peering at village houses. They include: Trawden, near Colne, on 3-5 July 2026 (gardens and scarecrows); Methley, near Leeds, on 4-5 July 2026; Kettlewell on 8-16 August 2026; and Norland in Calderdale on 4, 5, 6 September 2026.

Open Gardens 2026 - The UK National Directory

Another way to perhaps peep round the back of houses! Over 40 villages from Topley (Sheffield) to Robin Hood's Bay have an Open Gardens Event. Some have up to 22 gardens open to the public, for example Gargrave and Pickering. Full details at ngs.org.uk.

Chair: David Cant, 3 Middle Hathershelf, Luddendenfoot, Halifax HX2 6JQ, enquiries@yvbsg.org.uk

Secretary: Mary Cook, 34 Porter Close, Durham DH1 5ZL, secretary@yvbsg.org.uk or enquiries@yvbsg.org.uk

Membership Secretary: Pat Leggett, 11 Lonsdale Meadows, Boston Spa, West Yorks LS23 6DQ, membership-secretary@yvbsg.org.uk

Treasurer: Jan Goode, treasurer@yvbsg.org.uk

Archivist: David Cook, 34 Porter Close, Durham DH1 5ZL, archivist@yvbsg.org.uk

Yorkshire Buildings Editorial Team: Tony Berry, Tony Robinson, Beth Shurter, Mark Womersley, editor@yvbsg.org.uk

Newsletter, Web and Social Media: Lorraine Moor, 102 Queen Victoria Street, South Bank, York YO23 1HN, newsheet@yvbsg.org.uk